



ENGINEERING CHANGE NOTICE

Originator:	SHARAN GADE	Date:	August 16, 2022	Document Number:	ECN20220816-00
Phone No.:	(416) 754-3322	Revision Number:	1	SHEET:	1 of 2
Email Address:	Sgade@edac.net				
Department:	ENGINEERING				

CHANGE TYPE

- CLASS I Customer notification and approval required prior to implementation
- CLASS II Customer notification only, no approval required
- CLASS III No customer notification required

REASON OF CHANGE

634-015-274-990 update boardlock design for quality improvement

DESCRIPTION OF CHANGE:

New boardlock design. There are highlighted dimensions as per the below drawing related to the new boardlock design have been affected by ~0.50mm.

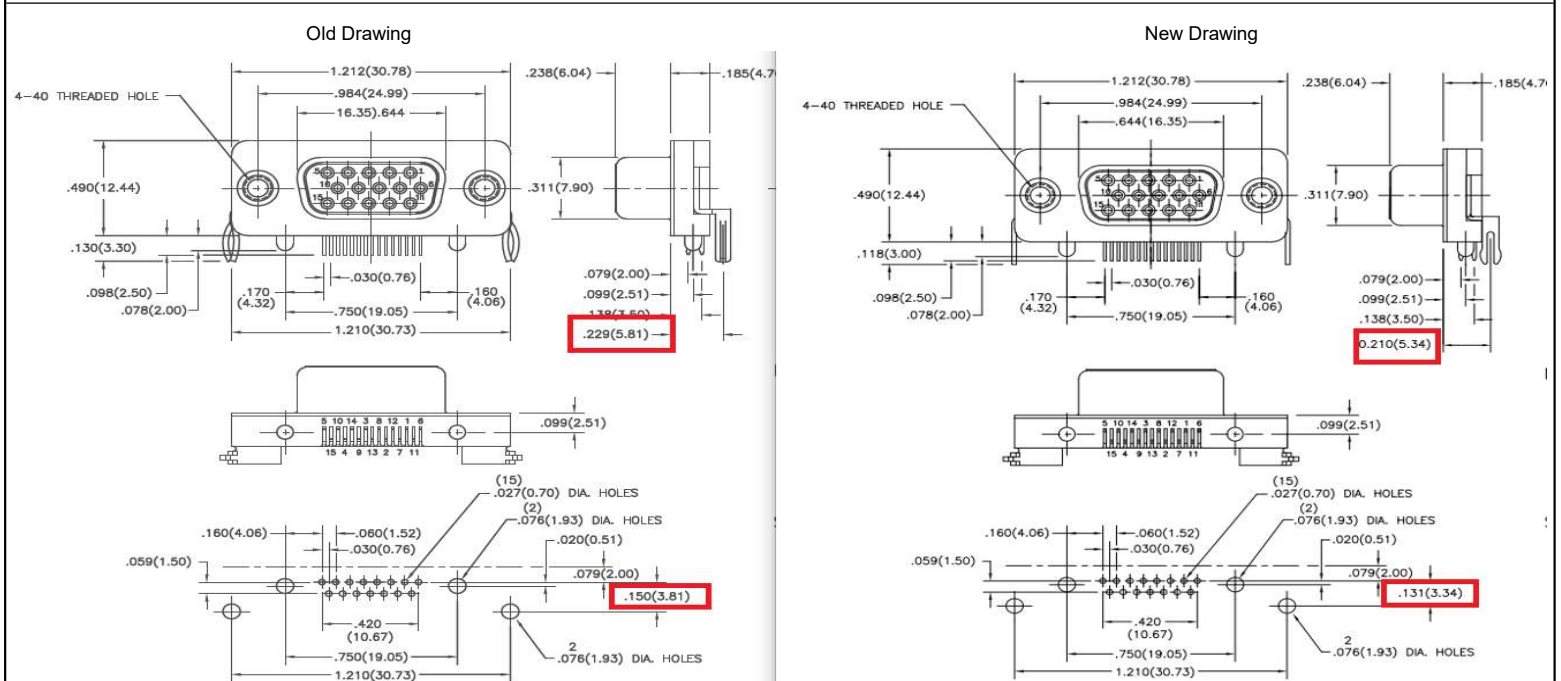

2. Effective implementation to distribution is on August 16, 2022

Note: N/A

PARTIES AFFECTED

- | | | |
|--|---|---|
| <input checked="" type="checkbox"/> Customer | <input type="checkbox"/> NORCOMP | <input checked="" type="checkbox"/> ECA |
| <input checked="" type="checkbox"/> Distributors | <input type="checkbox"/> MH | <input checked="" type="checkbox"/> EDG |
| <input type="checkbox"/> Suppliers | <input checked="" type="checkbox"/> ETW | <input checked="" type="checkbox"/> EDAC UK |

KEY TARGET DUE DATES IF CHANGE IS APPROVED TO PROCEED (check if applicable and show target dates as known)

- | | | | |
|--|-------|--|-------|
| <input type="checkbox"/> Submit Quote | _____ | <input type="checkbox"/> PPAP from Supplier | _____ |
| <input type="checkbox"/> Prod. Trial Run | _____ | <input type="checkbox"/> MRD of Production Parts | _____ |
| <input type="checkbox"/> Run at Rate | _____ | | |

ACKNOWLEDGEMENT FOR ECN INITIATION: (OPTIONALS)

Tooling Rep	_____	Process Eng Rep	_____
Mfg Eng Rep	_____	Facilities Rep	_____
Production Rep	_____	Sales Rep.	_____
Materials Rep	_____	Product Eng. Rep.	_____
Quality Rep	_____	Purchasing Rep	_____

STATUS

APPROVED

CCS CHANGE REQUEST #

REJECTED

Change REJECTED by:

Rejected Date:

APPROVALS FOR ECN INITIATION (REQUIRED)

<input type="checkbox"/>	<input type="checkbox"/>	President	<input type="checkbox"/>	<input checked="" type="checkbox"/>	Engineering Manager	Ronnie Sta. Monica
<input type="checkbox"/>	<input checked="" type="checkbox"/>	Vice President	Bob Sakitkovski	<input type="checkbox"/>	Mechanical Engineer	Sharan Gade

THIS IS A C.A.D. GENERATED DRAWING
DO NOT MAKE MANUAL REVISIONS TO MASTER.

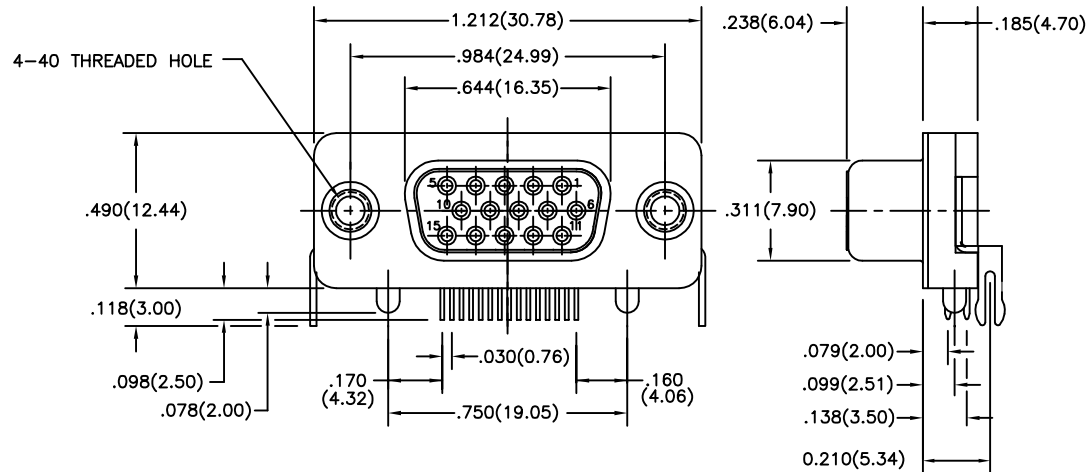

ALLOW TO HAVE EXTRAS CAVITIES
ON THIS SURFACE FOR SHRINKING
PURPOSE AS PER MOLDER REQUEST

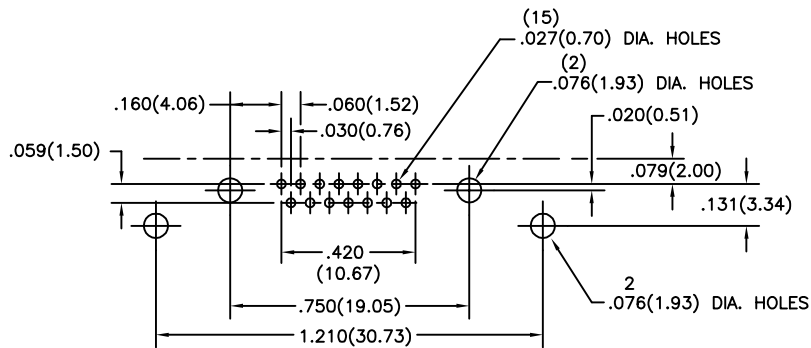
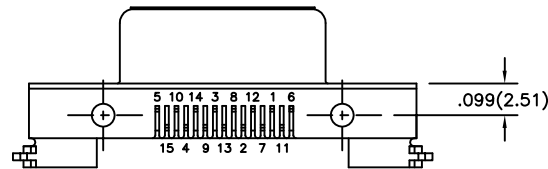
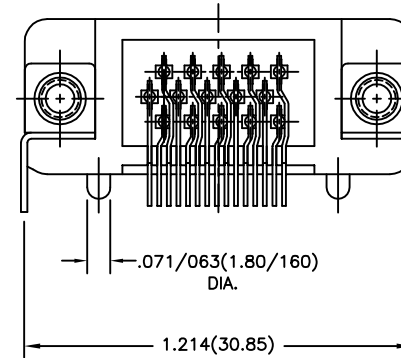

MATERIALS AND FINISH

- 1: STEEL, NICKEL PLATED
- 2: INSULATOR, NYLON 6T, COLOR PANTONE BLUE #2935U
- 3: CONTACTS: PHOSPHOR BRONZE, GOLD PLATED ON CONTACT AREA
TIN ON TAILS OVER NICKEL
- 4: BOARD LOCKS, BRASS TIN PLATED
- 5: RIVETS, BRASS NICKEL PLATED

SPECIFICATIONS

CURRENT RATING: 1 AMP MAX.
INSULATION RESISTANCE: 1000 MEGOHMS MIN. AT 500 VDC
DWD: 500 VAC rms FOR 1 MINUTE
CONTACT RESISTANCE: 30 MILLOHMS MAX.
TEMPERATURE RATING: -40°C +230°C
MAX. PROCESING TEMPERATURE: 265°C FOR 10 SEC. AND 230°C FOR 60 SEC.

CONTACT POSITION 9th RECESSED

ISSUE NUMBER

ORIGINAL ①

RoHS STATEMENT ADDED.
R.BLAKEY NOV 30/05 ②

PROCCESING TEMP. ADDED.
F.BRIONES DEC.12/05 ③

DIA. OF ALIGNMENT PINS
.063(1.60) AND HOLES ON
PCB LAYOUT .071(1.80)
WAS .073(185) AND .076(1.93)
F.BRIONES FEB.14/06 ④

DIM.1.240(31.49) WAS
1.210(30.73)
F.BRIONES APR.19/06 ⑤

DIM.1.210(30.73) ON B/LOCKS
WAS 1.240(31.49)
F.BRIONES NOV.23/06 ⑥

BOARDLOCKS WAS SINGLE
F.BRIONES NOV.2/09 ⑦

UPDATE BOARDLOCKS
.131(3.34) WAS .150(3.81)
.118(3.00) WAS .130(3.30)
J.L. AUG.08/22 ⑧

634 SERIES HDD SUBMINIATURE CONNECTOR
15 CONTACTS RECEPTACLE(SOCKET) RIGHT ANGLE ULTRA SLIM
WITH TRIPLE-BEAM BOARDLOCK

DRAWN: F.BRIONES DATE: JUNE 20/05

CHECKED: C.B. DATE: AUG 09/22

PART NUMBER
634-015-274-990

DRAWING NUMBER
634-015-274-990

ISSUE
8



THIS SERIES FULLY CONFORMS TO THE
EUROPEAN UNION DIRECTIVES
2011/65/EU FOR RoHS COMPLIANCY.



EDAC INC
TORONTO, ONTARIO
CANADA

YOUR CONNECTION TO QUALITY & SERVICE

THESE DRAWINGS AND SPECIFICATIONS
ARE THE PROPERTY OF EDAC INC., AND
SHALL NOT BE REPRODUCED, OR COPIED
OR USED AS THE BASIS FOR THE
MANUFACTURE OR SALE OF APPARATUS
WITHOUT WRITTEN PERMISSION.