



161 Alden Road, Units 7 & 8, Markham, Ontario Canada L3R 3W7

Tel: +1 416 754-3322

Fax: +1 416-754-3299

Email: info@edac.net

http://www.edac.net

ENGINEERING CHANGE NOTICE

<b>Originator:</b> _____ <b>Phone No.</b> _____ <b>Email Address:</b> _____ <b>Department</b> _____	<b>Harsh Patel</b>	<b>Date:</b> <b>May 13, 2021</b>	<b>Document Number</b> <b>ECN20210513-00</b>
	<b>(416) 754-3322</b>	<b>Revision Number</b> <b>1</b>	<b>SHEET</b> <b>1 of 5</b>
	<b>Hpatel@edac.net</b>		
	<b>ENGINEERING</b>		

CHANGE TYPE

- CLASS I** Customer notification and approval required prior to implementation
- CLASS II** Customer notification only, no approval required
- CLASS III** No customer notification required

REASON OF CHANGE

Discontinuance / End of Life of Part No-690-024-632-031 (USB 3.1 TYPE C FEMALE, 30u" Au Plating) & 690-024-633-031 ( USB 3.1 TYPE C FEMALE SMT, 30u" Au Plating)

DESCRIPTION OF CHANGE:

- EDAC decided to discontinue above parts due to low demand.
- Effective implementation to distribution is on May 13, 2021

PARTIES AFFECTED

- Customer
- Distributors
- Suppliers

- NORCOMP
- MH
- ETW

- ECA
- EDG
- EDAC UK

KEY TARGET DUE DATES IF CHANGE IS APPROVED TO PROCEED (check if applicable and show target dates as known)

<input type="checkbox"/> Submit Quote _____	<input type="checkbox"/> PPAP from Supplier _____
<input type="checkbox"/> Prod. Trial Run _____	<input type="checkbox"/> MRD of Production Parts _____
<input type="checkbox"/> Run at Rate _____	

ACKNOWLEDGEMENT FOR ECN INITIATION: (OPTIONALS)

<input type="checkbox"/> Tooling Rep _____	<input type="checkbox"/> Process Eng Rep _____
<input type="checkbox"/> Mfg Eng Rep _____	<input type="checkbox"/> Facilities Rep _____
<input type="checkbox"/> Production Rep _____	<input type="checkbox"/> Sales Rep. _____
<input type="checkbox"/> Materials Rep _____	<input type="checkbox"/> Product Eng. Rep. _____
<input type="checkbox"/> Quality Rep _____	<input type="checkbox"/> Purchasing Rep _____

STATUS	
APPROVED	<input type="checkbox"/>
CCS CHANGE REQUEST #	
REJECTED	<input type="checkbox"/>
Change REJECTED by:	
Rejected Date:	

APPROVALS FOR ECN INITIATION (REQUIRED)

	<b>President</b> _____		<b>Engineering Manager</b> _____	<b>Ronnie Sta. Monica</b>
	<b>Vice President</b> <b>Bob Sakitkovski</b>		<b>Mechanical Engineer</b> _____	<b>Harsh Patel</b>

MINIMUM OF TWO SIGNATURES REQUIRED



THIS SERIES FULLY CONFORMS TO THE  
EUROPEAN UNION DIRECTIVES  
2011/65/EU FOR ROHS COMPLIANCY.

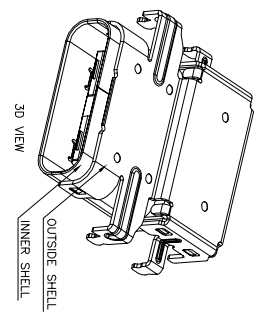
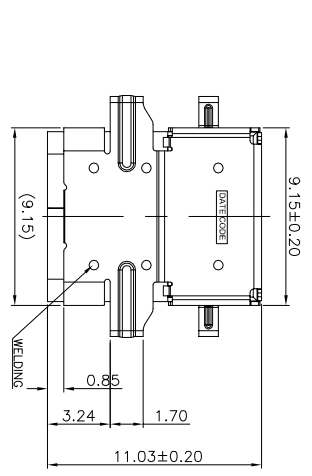

TOLERANCE UNLESS OTHERWISE SPECIFIED IN MM:	ANGLE
0.0	0, ±3°
0.00	0.0 ±2°
0.000	±0.15
	0.00 ±1°

THIS IS A C.A.D. GENERATED DRAWING  
DO NOT MAKE MANUAL REVISIONS TO MASTER.

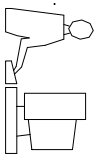

ISSUE NUMBER
CANCEL P/N ORIGINAL ①
690-024-232-031
P.M. MAY.13/2021 ②

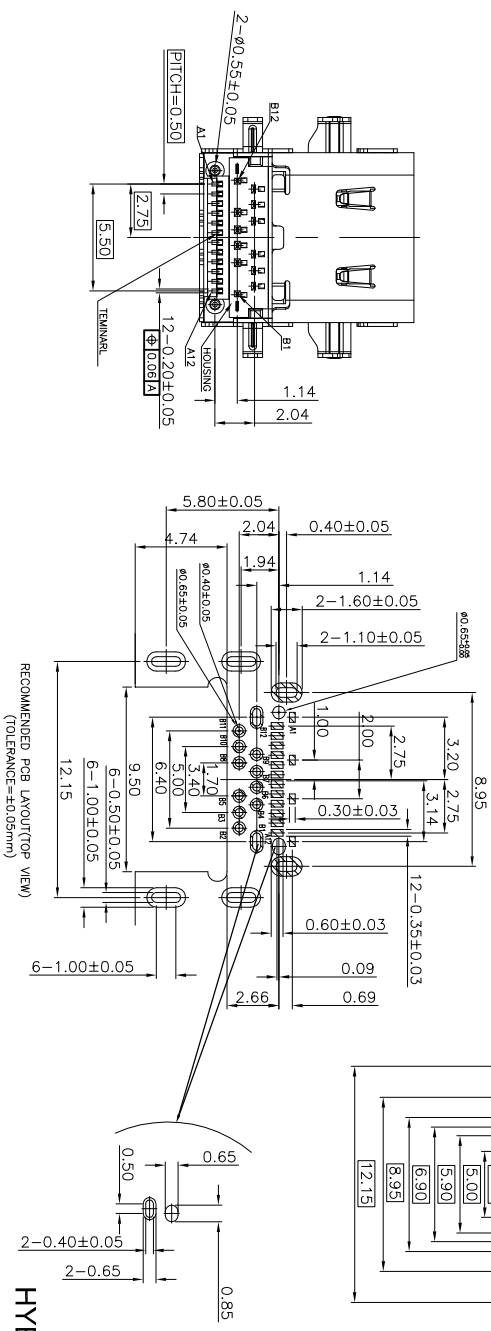
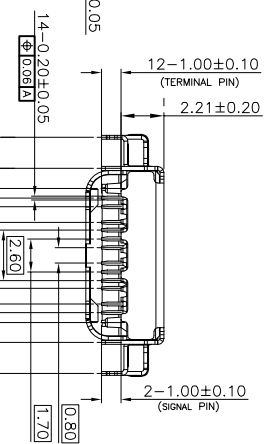
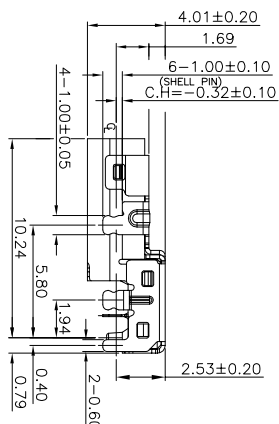
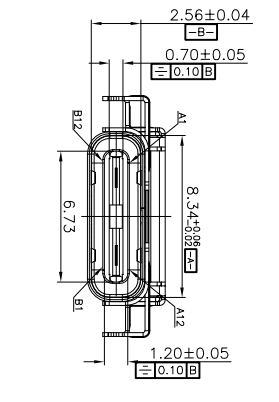

HYBRID MOUNT (THRU-HOLE AND SURFACE MOUNT)

PART NUMBERS	
GOLD FLASH	690-024-232-031
15U" GOLD	690-024-332-031

- NOTES:
- MATERIAL:
    - OUTSIDE SHELL: SUS301R-1/2H T=0.20mm
    - INNER SHELL: SUS301R-1/2H T=0.20mm
    - SIGNAL: SUS301R-1/2H T=0.10mm
    - R1 PAD: SUS301R-1/2H T=0.08mm
    - HOUSING: LCP+50%G.F. UL94UL-0 BLACK
    - TERMINAL: COPPER ALLOY T=0.10mm
  - PLATING SPECIFICATION
    - TERMINAL: GOLD PLATING ON MATING AREA, MATTE Sn 120~200u" ON SOLDERING AREA, 80~150u" NICKEL UNDER PLATING OVERALL
    - SHELL: NICKEL PLATED 60u" MIN.
  - MECHANICAL PERFORMANCE
    - INSERTION FORCE: 5N~20N.
    - WITHDRAWAL FORCE: 8N~20N.
    - DURABILITY: 10000 CYCLES.
  - ELECTRICAL PERFORMANCE
    - CURRENT RATING: 1A.
    - ILCCR: CONTACT: 40 mΩ MAX(INITIAL).
    - INSULATION RESISTANCE: UNMATED: 100 MΩ MIN.
    - DIELECTRIC WITHSTAND VOLTAGE: 100V AC.
  - IR REFLOW:
 

THE PEAK TEMPERATURE ON BOARD SHALL BE MAINTAINED FOR 10 SECONDS AT 260±5°C.
  - OPERATING TEMPERATURE RANGE: -40°C~85°C (WITHOUT LOSS FUNCTION).

# USB 3.1 TYPE C FEMALE

EDAC INC  
TORONTO, ONTARIO  
CANADA  
YOUR CONNECTION TO QUALITY & SERVICE

THESE DRAWINGS AND SPECIFICATIONS ARE THE PROPERTY OF EDAC INC. AND SHALL NOT BE REPRODUCED OR COPIED OR USED AS THE BASIS FOR THE MANUFACTURE OR SALE OF APPARATUS WITHOUT WRITTEN PERMISSION.

ACAD REFERENCE NO.: 690-024-232-031	DATE: JUN.29/2015
DRAWN: N.SONDH	DATE: MAY. 13/2021
CHECKED: R.S.M.	
PART NUMBER	SHEET 1 OF 2
SEE TABLE	ISSUE
DRAWING NUMBER	2
690-024-232-031	

TOLERANCE UNLESS OTHERWISE SPECIFIED IN MM:

TOLERANCE	ANGLE
0.0	0°
±0.25	±3°
±0.15	±2°
±0.15	±1°

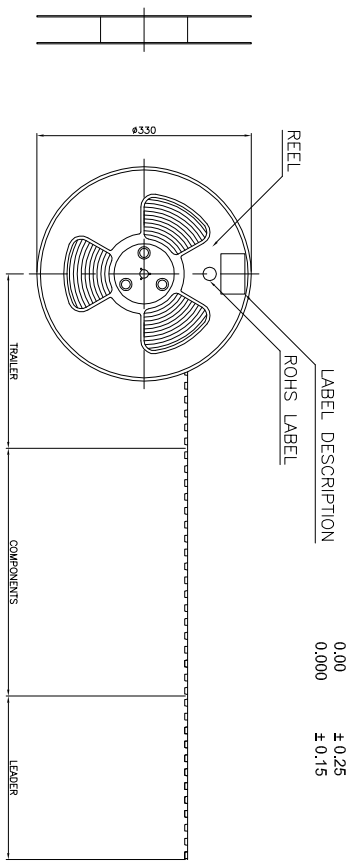

GATHER MATERIAL DIRECTION      INPUT MATERIAL DIRECTION

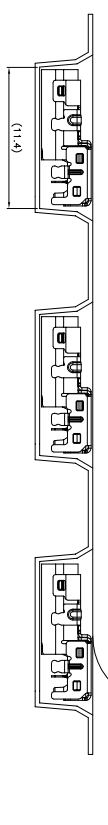
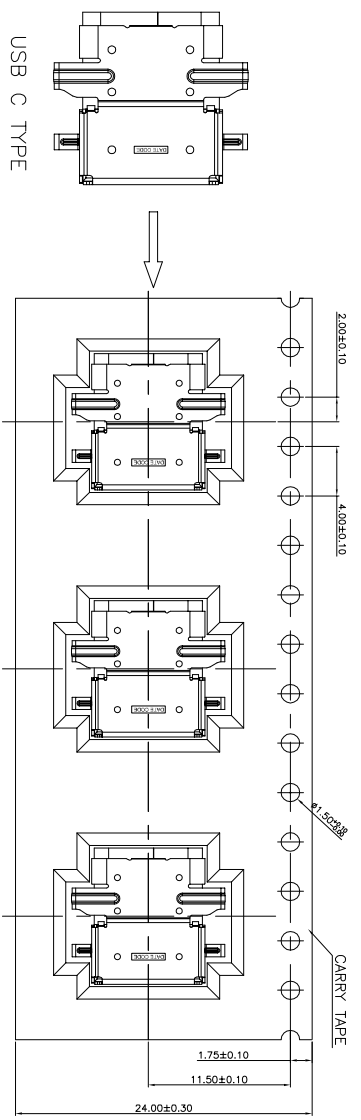

Notes:

1. THE START AND END OF EACH REEL, BASED ON THE ACTUAL QUANTITY, RESERVED 5--15PCS SPACE;
2. COVER TAPE AND CARRY TAPE PEEL: 10g~130g; PEEL DEG.:165°~175°;
3. QTY: 700PCS/REEL, 5REEL/CARTON, TOTAL 3500PCS/CARTON;

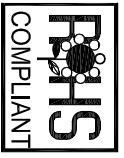
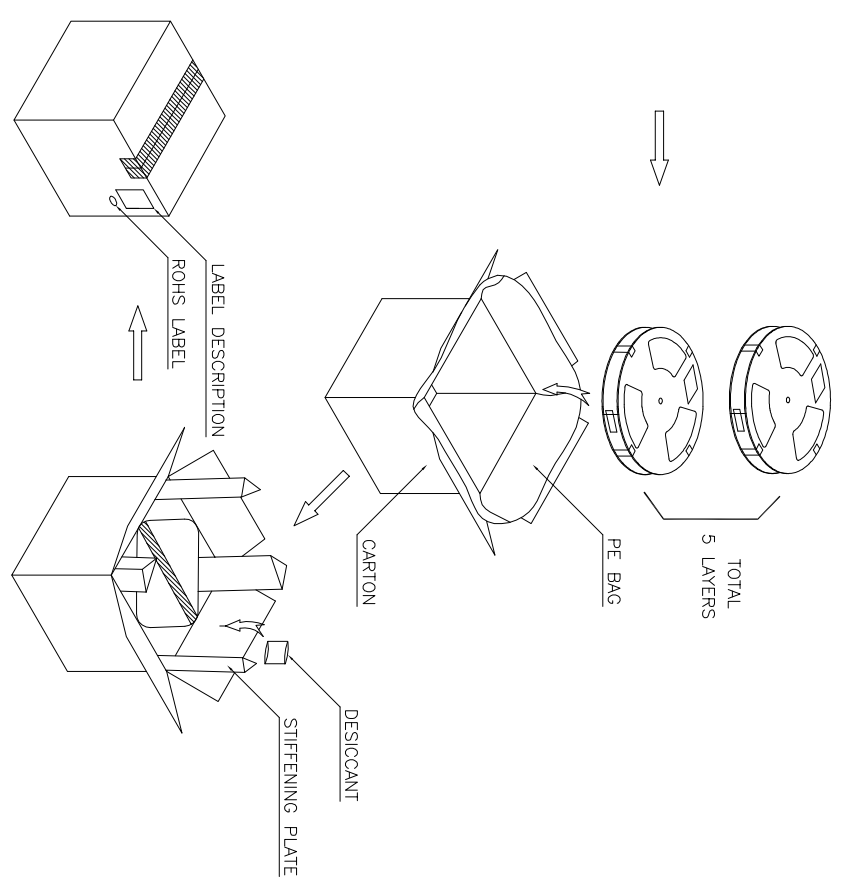

THIS SERIES FULLY CONFORMS TO THE EUROPEAN UNION DIRECTIVES 2011/65/EU FOR ROHS COMPLIANCY.

# USB 3.1 TYPE C FEMALE

**EDAC INC**  
TORONTO, ONTARIO  
CANADA  
YOUR CONNECTION TO QUALITY & SERVICE

THESE DRAWINGS AND SPECIFICATIONS ARE THE PROPERTY OF EDAC INC. AND SHALL NOT BE REPRODUCED OR COPIED OR USED AS THE BASIS FOR THE MANUFACTURE OR SALE OF APPARATUS WITHOUT WRITTEN PERMISSION.

ACAD REFERENCE NO.: 690-024-232-031	
DRAWN: N.SONDH	DATE: JUN.29/2015
CHECKED: R.S.M.	DATE: MAY.13/2021
PART NUMBER	SHEET 2 OF 2
DRAWING NUMBER	ISSUE
690-024-232-031	2

TOLERANCE UNLESS OTHERWISE SPECIFIED IN MM:  
 .000 ± 0.10  
 .00 ± 0.20  
 .0 ± 0.30  
 ANGLE ± 2

THIS IS A C.A.D. GENERATED DRAWING  
 DO NOT MAKE MANUAL REVISIONS TO MASTER.

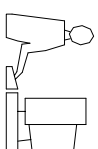

ISSUE NUMBER	ORIGINAL
1	
2	DRAWING UPDATED N.SONDH MAR 01/2016
3	CANCEL PIN 690-024-233-031 MAY 13/2021

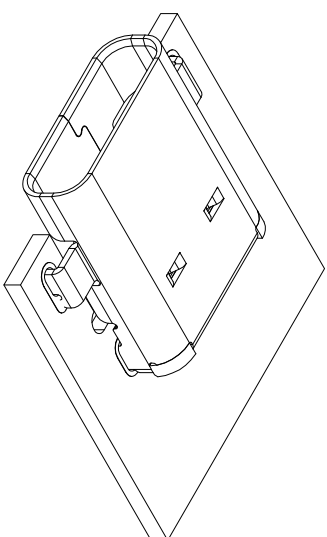
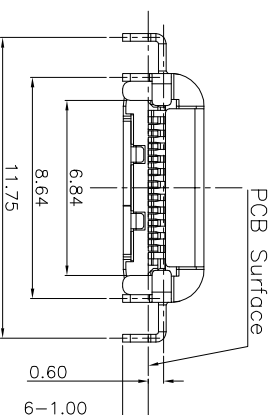
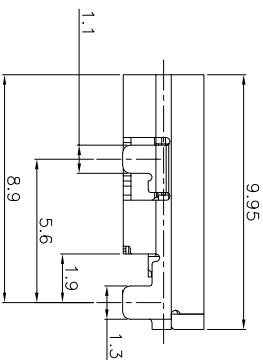
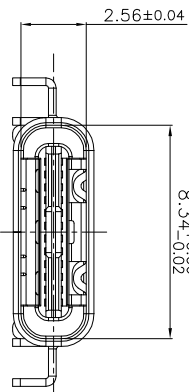
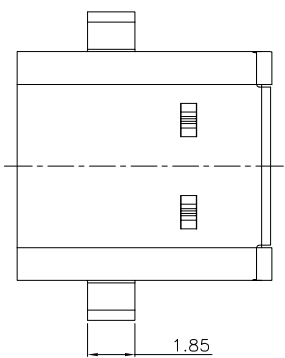

PART NUMBERS	
GOLD FLASH	690-024-233-031
15u"GOLD	690-024-333-031

**NOTES:**

- 1.MATERIAL:**  
 HOUSING: LCP,305GF,UL94V-0,COLOR:BLACK  
 CONTACT: COPPER ALLOY  
 SHELL: STAINLESS STEEL  
 GUARD: STAINLESS STEEL  
 SPRING: STAINLESS STEEL
- 2.Finish:**  
 CONTACT: GOLD PLATING ON CONTACT AREA  
 GOLD FLASH PLATING ON SOLDERTAILS  
 80u"Min Ni UNDERPLATING OVER ALL  
 SHELL: 50u"Min NIPPLATING OVER ALL.
- 3.PRODUCT SPECIFICATION:**  
 VOLTAGE RATING:100V AC  
 INSULATION RESISTANCE:100M Ω MIN  
 CONTACT RESISTANCE: 40mΩ MAX  
 INSERT FORCE: 5-20N MAX.  
 EXTRACT FORCE: 8-20N MIN.  
 DURABILITY : 10000 CYCLES

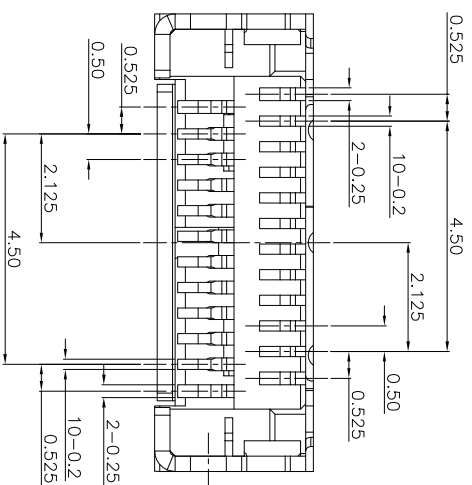
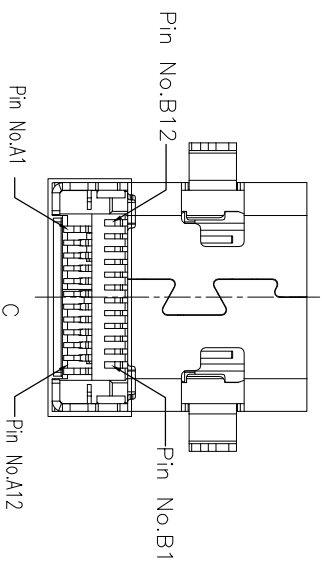

DETAIL C (SCALE 2:1)



THIS SERIES FULLY CONFORMS TO THE  
 EUROPEAN UNION DIRECTIVES  
 2011/65/EU FOR ROHS COMPLIANCY.

**USB 3.1 TYPE C FEMALE SMT**

(Mid - Mount, Dual - Row SMT)

EDAC INC TORONTO, ONTARIO CANADA		YOUR CONNECTION TO QUALITY & SERVICE	
THESE DRAWINGS AND SPECIFICATIONS ARE THE PROPERTY OF EDAC INC, AND SHALL NOT BE REPRODUCED, OR COPIED OR USED AS THE BASIS FOR THE MANUFACTURE OR SALE OF APPARATUS WITHOUT WRITTEN PERMISSION.			
ACAD REFERENCE NO.:	690-024-233-031		
DRAWN:	N.SONDH	DATE:	JUN.24/2015
CHECKED:	R.S.M.	DATE:	MAY.13/2021
PART NUMBER	SEE TABLE	SHEET	1 OF 2
DRAWING NUMBER	690-024-233-031	ISSUE	3

TOLERANCE UNLESS OTHERWISE  
 SPECIFIED IN MM:  
 ± 0.10  
 ± 0.20  
 ± 0.30  
 ± 0.50  
 ANGLE ± 2°

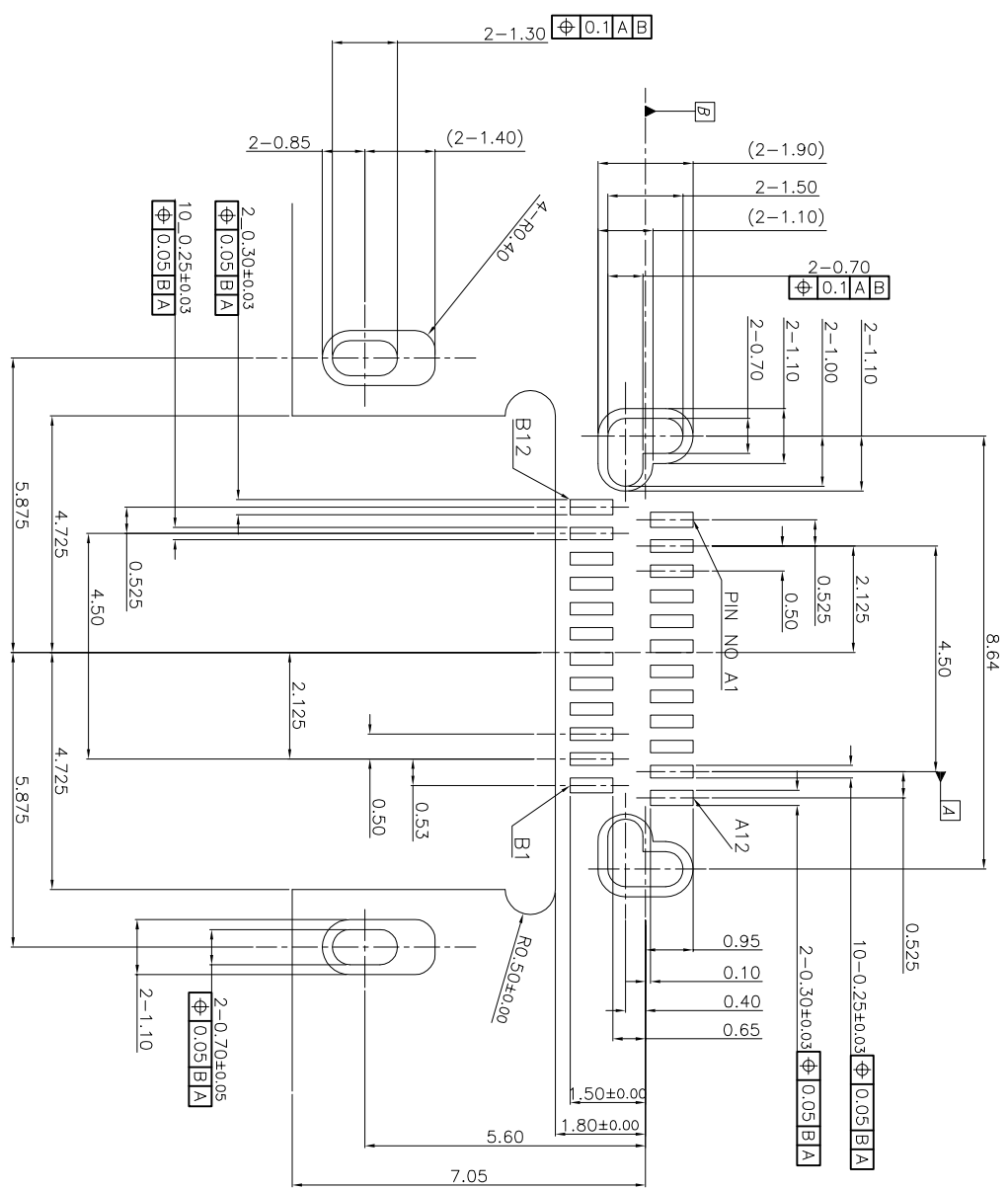

PIN NUMBER	SIGNAL NAME	DESCRIPTION
A1	GND	Ground Return
A2	SSTX+	SuperSpeed differential pair
A3	SSTX-	SuperSpeed differential pair
A4	VBUS	Bus Power
A5	CC1	Configuration Channel
A6	D+	USB 2.0 differential pair
A7	D-	USB 2.0 differential pair
A8	RFU1	Reserved for Future use
A9	VBUS	Bus Power
A10	SSRX-	SuperSpeed differential pair
A11	SSRX+	SuperSpeed differential pair
A12	GND	Ground Return

PIN NUMBER	SIGNAL NAME	DESCRIPTION
B12	GND	Ground Return
B11	SSRX+	SuperSpeed differential pair
B10	SSRX-	SuperSpeed differential pair
B9	VBUS	Bus Power
B8	RFU2	Reserved for Future use
B7	D-	USB 2.0 differential pair
B6	D+	USB 2.0 differential pair
B5	CC2	Configuration Channel
B4	VBUS	Bus Power
B3	SSTX-	SuperSpeed differential pair
B2	SSTX+	SuperSpeed differential pair
B1	GND	Ground Return

NOTE: Tx and Rx are defined from the host perspective

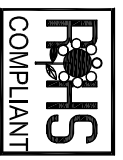

THIS SERIES FULLY CONFORMS TO THE  
 EUROPEAN UNION DIRECTIVES  
 2011/65/EU FOR ROHS COMPLIANCY.

# USB 3.1 TYPE C FEMALE SMT

(Mid - Mount, Dual - Row SMT)

**EDAC INC**  
 TORONTO, ONTARIO  
 CANADA  
 YOUR CONNECTION TO QUALITY & SERVICE

THESE DRAWINGS AND SPECIFICATIONS  
 ARE THE PROPERTY OF EDAC INC. AND  
 SHALL NOT BE REPRODUCED, COPIED  
 OR USED AS THE BASIS FOR THE  
 MANUFACTURE OR SALE OF APPARATUS  
 WITHOUT WRITTEN PERMISSION.

ACAD REFERENCE NO.:	690-024-233-031
DRAWN:	N.SONDH
CHECKED:	R.S.M.
DATE:	JUN:24/2015
DATE:	MAY:13/2021
PART NUMBER	SEE TABLE
DRAWING NUMBER	690-024-233-031
SHEET	2 OF 2
ISSUE	3